

DRIVING DIRECTIONS:

Bone and Joint Hospital at St. Anthony is located at 1111 N. Dewey Ave. in Oklahoma City. Our campus is easily accessible from all major thoroughfares in the city.

SOUTHBOUND I-235 (Broadway Extension):

1. Take EXIT 1G (RIGHT) toward N. 10TH STREET
2. Stay STRAIGHT to go onto N. OKLAHOMA AVE.
3. Turn RIGHT onto NE 10TH STREET
4. Turn RIGHT onto N. DEWEY AVE.

WESTBOUND I-40:

- 1: Start out going West on I-40 W
- 2: Take the CLASSEN BLVD exit- exit number 149B.
- 3: Take the CLASSEN BLVD NORTH ramp.
- 4: Merge onto S CLASSEN BLVD.
- 5: Turn RIGHT onto NW 10TH ST.
- 6: Turn LEFT onto N DEWEY AVE.

EASTBOUND I-40:

- 1: Start out going East on I-40 E
- 2: Take the HARVEY AVE exit- exit number 150B.
- 3: Stay straight to go onto SW 4TH ST.
- 4: Turn RIGHT onto S WALKER AVE.
- 5: Turn LEFT onto NW 10TH ST.
- 6: Turn RIGHT onto N DEWEY AVE.

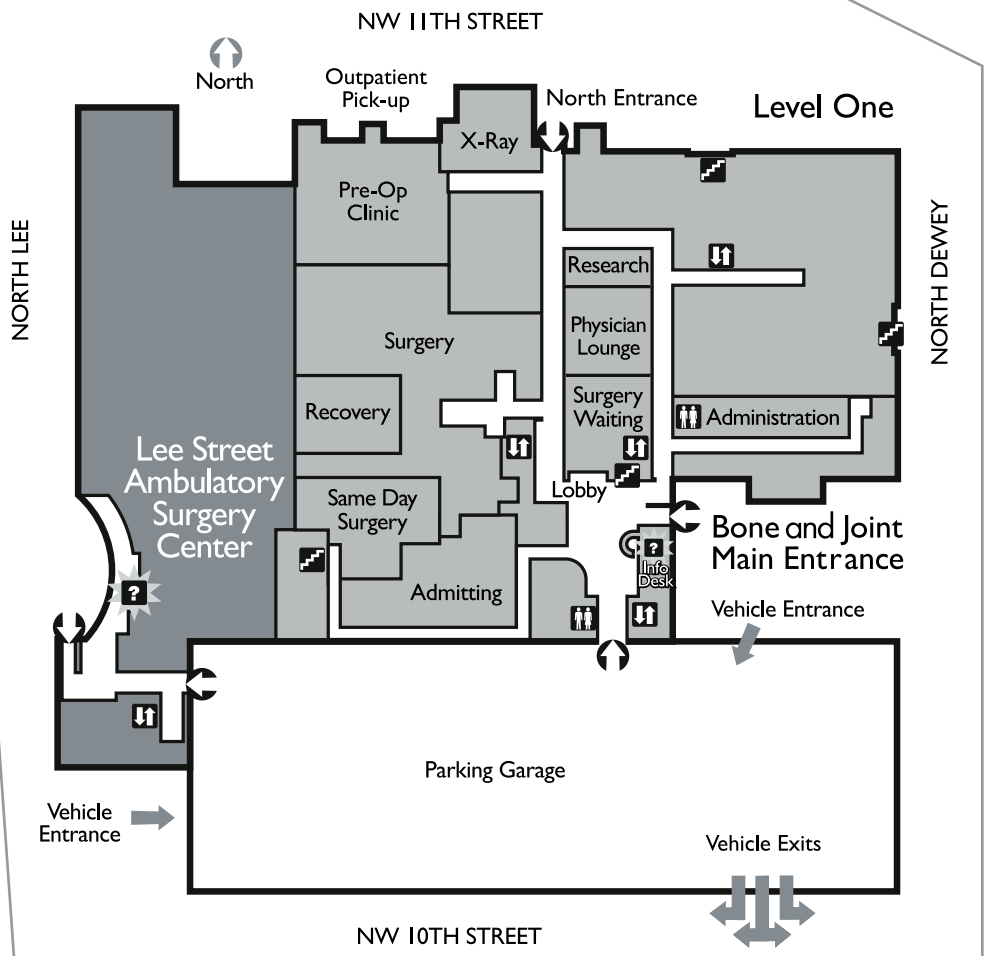

1111 NORTH DEWEY AVENUE

OKLAHOMA CITY, OK

MAIN PHONE (405) 272-9671

PHYSICIAN REFERRAL LINE (405) 272-7900

WWW.BONEANDJOINT.COM